

# Duro-Guard® ISO Insulation

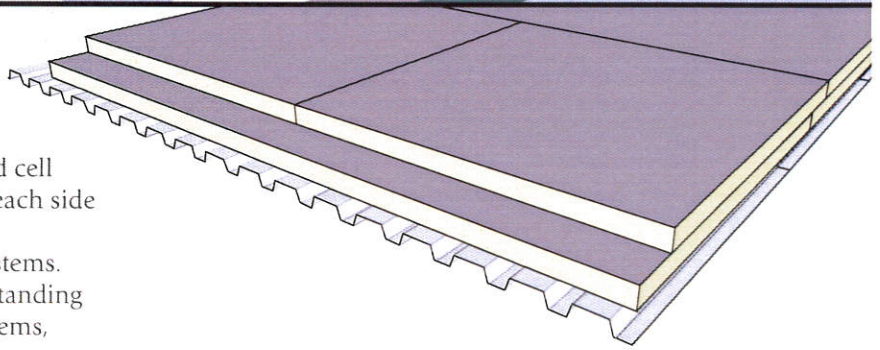

## PRODUCTS

### Duro-Guard ISO II

- Rigid roof insulation panel composed of a closed cell polyisocyanurate foam core bonded on-line on each side to fiber reinforced facers.
- Ideal for controlling costs in typical insulated systems.
- Applications include single-ply roofing systems, standing seam metal roof systems, modified bitumen systems, and BUR.
- Provides R-values from 5.7 to 26.8.
- Available in flat or tapered panels.

### Duro-Guard ISO III CG

- Rigid roof insulation panel composed of a closed cell polyisocyanurate foam core laminated on-line to a premium performance coated glass facer.
- Offers excellent fire and mold resistance.
- Applications include single-ply roofing systems, modified bitumen systems, BUR, and coal-tar.
- Provides R-values from 5.7 to 26.8.
- Available in flat or tapered panels.

### Duro-Guard ISO HD

- $\frac{1}{2}$ " thick high density polyisocyanurate insulation panel specifically designed for use as a cover board; manufactured on-line using premium performance coated glass facers.
- Ideal for use as an insulation cover board or recover board in reroofing applications.
- Applications include single-ply roofing systems and modified bitumen systems.
- Delivers an R-value of 2.5, significantly higher than roof cover boards made with other materials such as wood-fiber or gypsum.
- Sturdy construction and durability protects the roof system from effects of hail, roof top construction traffic and other potentially damaging elements.

### Duro-Guard ISO HD Composite

- $\frac{1}{2}$ " thick high density polyisocyanurate cover board laminated during the manufacturing process to Duro-Guard ISO III CG rigid polyiso roof insulation.
- Eliminates the need for a cover board.
- Applications include single-ply roofing systems, modified bitumen systems, and BUR.
- Ideal for commercial roofing projects that require high thermal efficiency combined with maximum durability.
- Provides R-values from 11.1 to 23.0.

### Duro-Guard ISO Flat - HP

- Rigid roof insulation panel composed of a closed cell polyisocyanurate foam core laminated to heavy, durable, and dimensionally stable coated-glass facers.
- Ideal for fully adhered applications requiring enhanced wind uplift, fire, and mold resistance.
- Applications include single-ply roofing systems, modified bitumen systems, and BUR.
- Provides R-values values from 5.7 to 26.8.
- Available in flat or tapered panels.

### Duro-Guard ISO NB

- Rigid roof insulation panel composed of a closed cell polyisocyanurate foam core bonded during the manufacturing process to fiber reinforced facers on one side and oriented strand board (OSB) or plywood on the other side.
- Applications include single-ply roofing systems, standing seam metal roof systems, and heavyweight shingles.
- Provides R-values from 6.3 to 24.2.
- Substrate types:
  - $\frac{7}{16}$ " or  $\frac{3}{8}$ " OSB
  - $\frac{3}{8}$ " or  $\frac{1}{2}$ " plywood

### Duro-Guard ISO Foil

- Rigid roof insulation panel composed of a closed cell polyisocyanurate foam core bonded on-line to an impermeable foil facing.
- Ideal for areas where moisture drive may be present.
- Applications include ballasted and mechanically attached single-ply roofing systems.
- Provides R-values from 6.7 to 31.2.
- Available in flat or tapered panels.